

Townhome Floorplan C

4 BEDROOM
2.5 BATHROOM

Interior	1,620 - 1,621 sf
Balcony	93 sf
Garage	224 sf

In Good Form

- 1. Built-in entry niche with feature lighting
- 2. Spacious kitchen with 226 ft³ of storage
- 3. Full height pantry and integrated storage closet
- 4. Custom integrated hood fan
- 5. Wall mounted pot rail above the range
- 6. Slide-out organics and recycling storage
- 7. Tiled wall niche in shower
- 8. Air conditioning for main floor and primary bedroom
- 9. Garage pre-wired for EV charging capability
- 10. Semi-private outdoor spaces for every home
- 11. Driveway parking

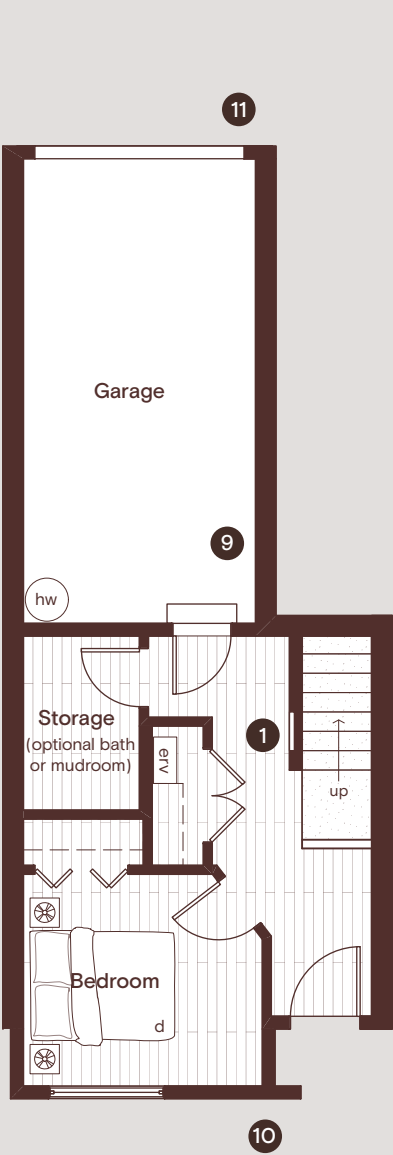

LOWER

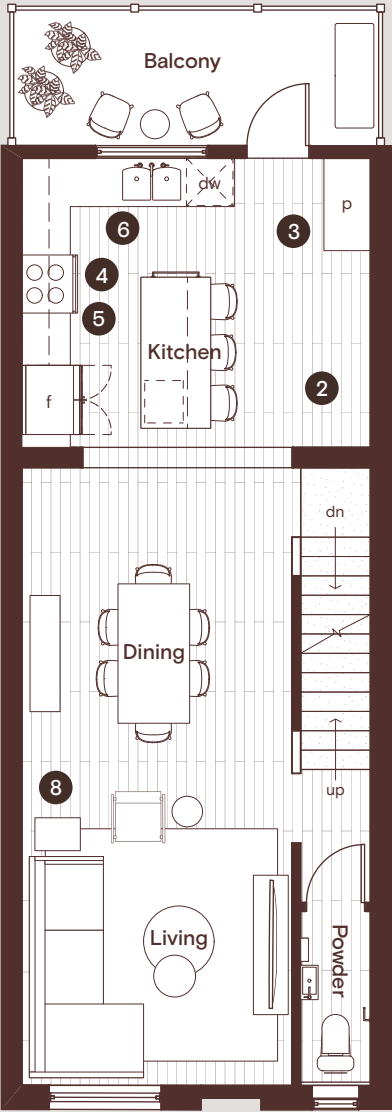

MAIN



UPPER